

Parts List

AC49610

Scrolls Saw Conversion Kit

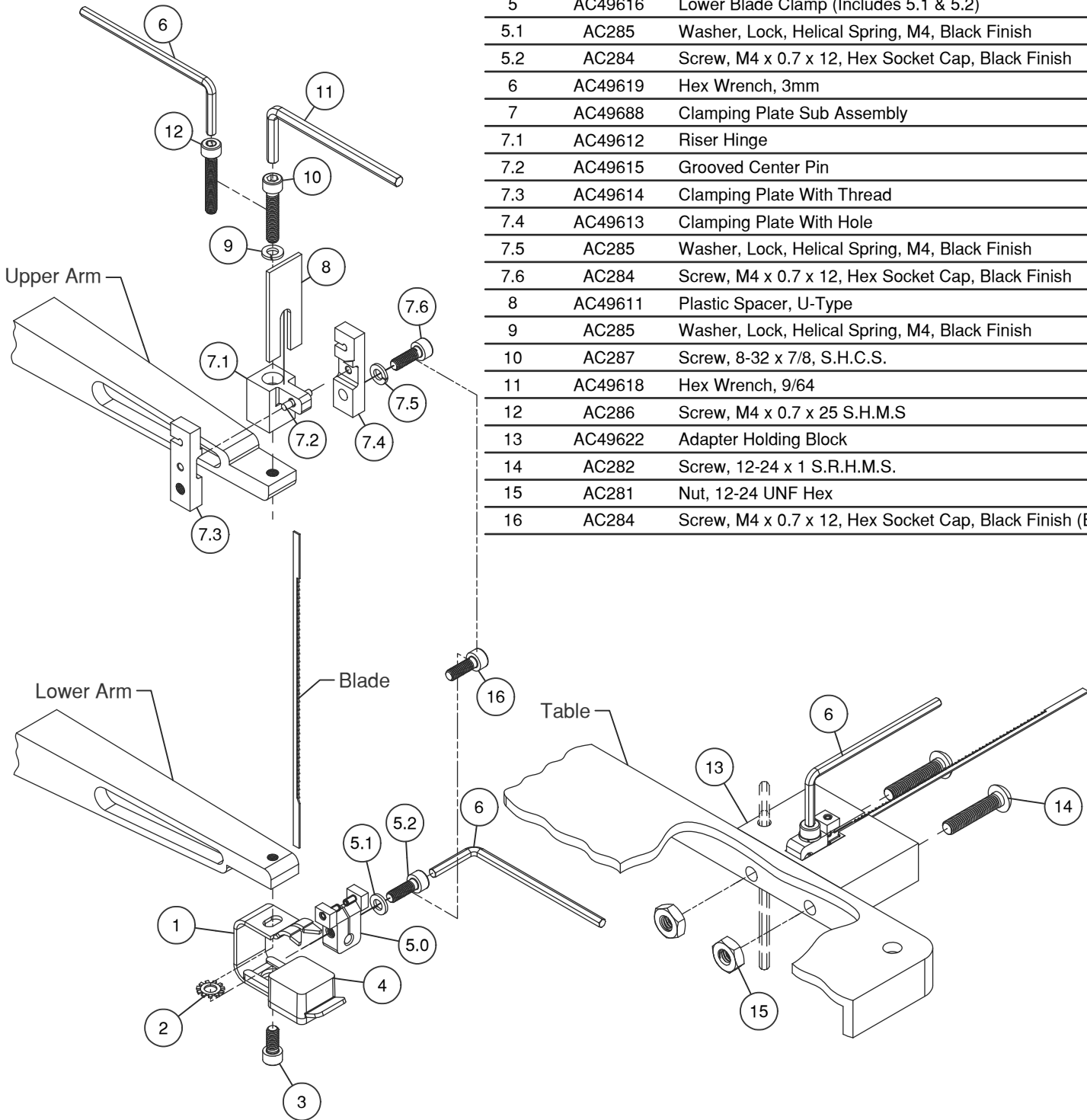

Item	Part No.	Description	Qty
1	AC49617	Lower Blade Holder	1
2	AC49609	Lockwasher, #8 External	1
3	AC283	Screw, 8-32 x 3/8, S.H.C.S	1
4	AC49624	Rubber Bumper, Holder	1
5	AC49616	Lower Blade Clamp (Includes 5.1 & 5.2)	1
5.1	AC285	Washer, Lock, Helical Spring, M4, Black Finish	1
5.2	AC284	Screw, M4 x 0.7 x 12, Hex Socket Cap, Black Finish	1
6	AC49619	Hex Wrench, 3mm	1
7	AC49688	Clamping Plate Sub Assembly	1
7.1	AC49612	Riser Hinge	1
7.2	AC49615	Grooved Center Pin	1
7.3	AC49614	Clamping Plate With Thread	1
7.4	AC49613	Clamping Plate With Hole	1
7.5	AC285	Washer, Lock, Helical Spring, M4, Black Finish	1
7.6	AC284	Screw, M4 x 0.7 x 12, Hex Socket Cap, Black Finish	1
8	AC49611	Plastic Spacer, U-Type	1
9	AC285	Washer, Lock, Helical Spring, M4, Black Finish	1
10	AC287	Screw, 8-32 x 7/8, S.H.C.S.	1
11	AC49618	Hex Wrench, 9/64	1
12	AC286	Screw, M4 x 0.7 x 25 S.H.M.S	1
13	AC49622	Adapter Holding Block	1
14	AC282	Screw, 12-24 x 1 S.R.H.M.S.	2
15	AC281	Nut, 12-24 UNF Hex	2
16	AC284	Screw, M4 x 0.7 x 12, Hex Socket Cap, Black Finish (Extra)	1

OLSON[®] Band & Scroll Saw Blades

16 Stony Hill Rd., Bethel, CT 06801 • 203-792-8622
 Fax: 203-796-7861 • www.olson.net

For 16" Scroll Saws, this is a list identifying if an English 8-32 screw is used to secure item 6.1 Riser Hinger or if metric screw is used.

Item #9 8-32 x 7/8 Screw	Item #11 M4 x .07 x 25 Screw	Not Included M5 x .75 x 25mm	Unknow
Sears Models 23611 & 23612	Ryobi Model SC 160	Grizzly Go536 VS-16	Skill Model 3330-3335
Dremel Models 1671 & 1695	Central Machinery Models S 5909, 62519, 93012		Amt Models 4601 and 4602
	Northern Hydraulics Model SS16		Reliant Models DD66 and DD67
	Proxxon Micromot DSH-2		Hafco B-18V
	Shop Fox W1713-16		Einhell TH-405E
	Rikon Model 10-600VS,		Record SS-16V
	Wen 3920-3921		Scheppach Models SD1600, 240VS
			Deco 405, 88002123